



## Sandringham Court, Priory Field Drive

**Price £350,000**

Located on one of Edgware's premier tree lined turnings, is this well proportioned 2 bedroom, 2 bathroom ground floor apartment. The property boasts a spacious living room, separate kitchen, 2 bedrooms ( one with en-suite) fitted wardrobes and a family bathroom. Further benefits include off-street parking, ample storage and within walking distance to Edgware's high street and close to Mill Hill Broadway. Chain Free. Sole Agent.

Lease: over 900 years

Service charge: £140 per month

Ground Rent: £10 a year

### Viewing

Please contact our Mill Hill Office on 020 8959 0011 if you wish to arrange a viewing appointment for this property or require further information.



# Floor Plan

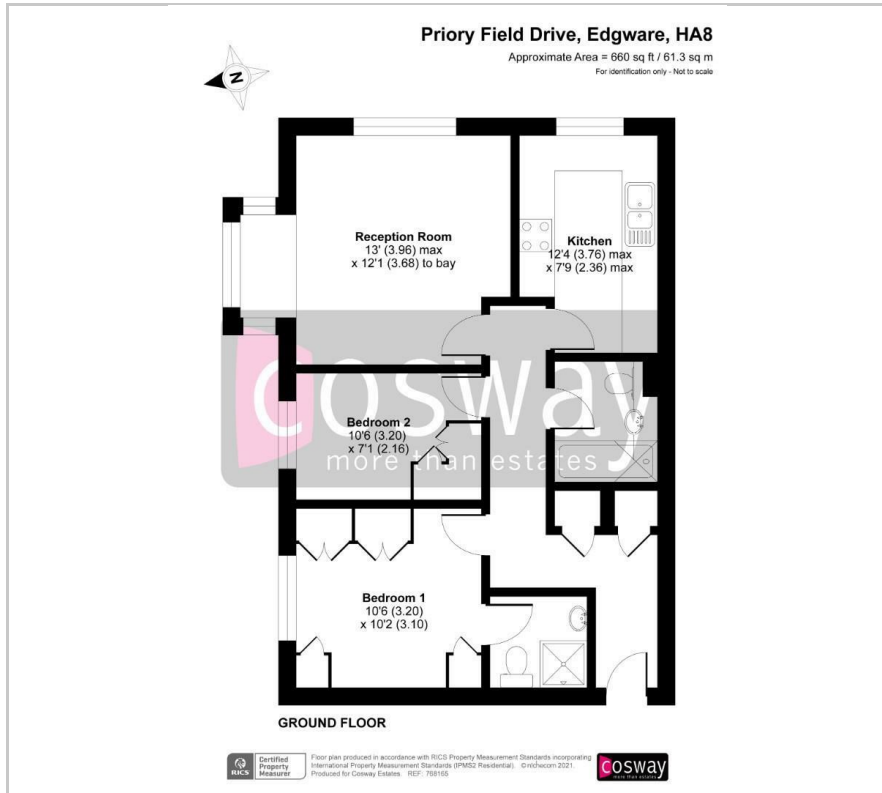

# Area Map



# Energy Efficiency Graph

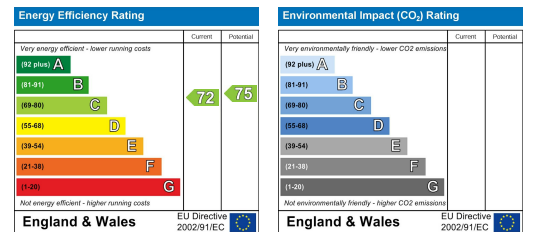

These particulars, whilst believed to be accurate are set out as a general outline only for guidance and do not constitute any part of an offer or contract. Intending purchasers should not rely on them as statements of representation of fact, but must satisfy themselves by inspection or otherwise as to their accuracy. No person in this firm's employment has the authority to make or give any representation or warranty in respect of the property.